



Camlet Way

Hadley Wood, Barnet, EN4 0NL

Guide Price £3,000,000



Camlet Way

Hadley Wood, Barnet, EN4 0NL

An imposing detached five-bedroom family residence occupying a magnificent plot of approximately 0.51 acres on the prestigious Camlet Way, one of Hadley Wood's most sought-after locations. This exceptional home enjoys far-reaching panoramic views across the surrounding green belt countryside and offers substantial scope for extension or redevelopment, subject to the necessary planning consents.

An impressive galleried reception hall features a sweeping staircase and leads to generous accommodation throughout. The principal reception room is beautifully arranged with a dual aspect and a striking picture-frame window designed to maximise the incredible green belt views. Further ground floor accommodation includes a substantial family room, formal dining room and an additional day room opening onto the fitted kitchen, equipped with a separate utility room, and a guest cloakroom with shower facilities.

The first floor spacious galleried landing leads to five generously sized bedrooms, a family bathroom and separate WC. The bedroom suite benefits from fitted wardrobes and a private en suite shower room, whilst bedroom three also enjoys access to its own newly refurbished shower room.

The beautifully maintained rear garden extends to approximately 171ft and provides a wonderful sense of privacy and tranquillity. A large terrace leads onto an expansive lawn bordered by mature planting.

An extensive front approach provides a gated carriage driveway with parking for numerous vehicles and gives access to a substantial double garage with space for up to four cars.

Perfectly positioned and ideal for the commuter with Hadley Wood mainline a nearby walk and offers direct access to London Kings Cross and Moorgate.

The area is also known for its excellent schools.

EPC : E
ENFIELD COUNCIL TAX BAND : H
TENURE : Freehold





SEAN HEANEY
HOMES & PROPERTY



SEAN HEANEY



SEAN HEANEY



SEAN HEANEY



SEAN HEANEY



SEAN HEANEY
HOMES & PROPERTY

GROUND FLOOR

Entrance Hall

14'6 x 17'2 (4.42m x 5.23m)

Dining Room

13'0 x 17'4 (3.96m x 5.28m)

Reception Room

18'11 x 26'8 (5.77m x 8.13m)

Lobby

Guest Shower Room

Living Room

24'1 x 18'7 (7.34m x 5.66m)

Family Room

14'9 x 12'0 (4.50m x 3.66m)

Kitchen

10'10 x 9'3 (3.30m x 2.82m)

Utility

10'10 x 5'10 (3.30m x 1.78m)

GARAGE

16'9 x 38'11 (5.11m x 11.86m)

FIRST FLOOR

Landing

Bedroom One

14'1 x 19'7 (4.29m x 5.97m)

En-Suite

Bedroom Two

17'7 x 15'3 (5.36m x 4.65m)

Family Bathroom

7'1 x 8'5 (2.16m x 2.57m)

Bedroom Three

12'10 x 15'9 (3.91m x 4.80m)

En-Suite

5'8 x 5'8 (1.73m x 1.73m)

Bedroom Five

7'11 x 9'5 (2.41m x 2.87m)

Storage Cupboards

WC

Bedroom Four

14'11 x 9'7 (4.55m x 2.92m)

Eave Storage

4'2 x 11'10 (1.27m x 3.61m)

Floor Plan

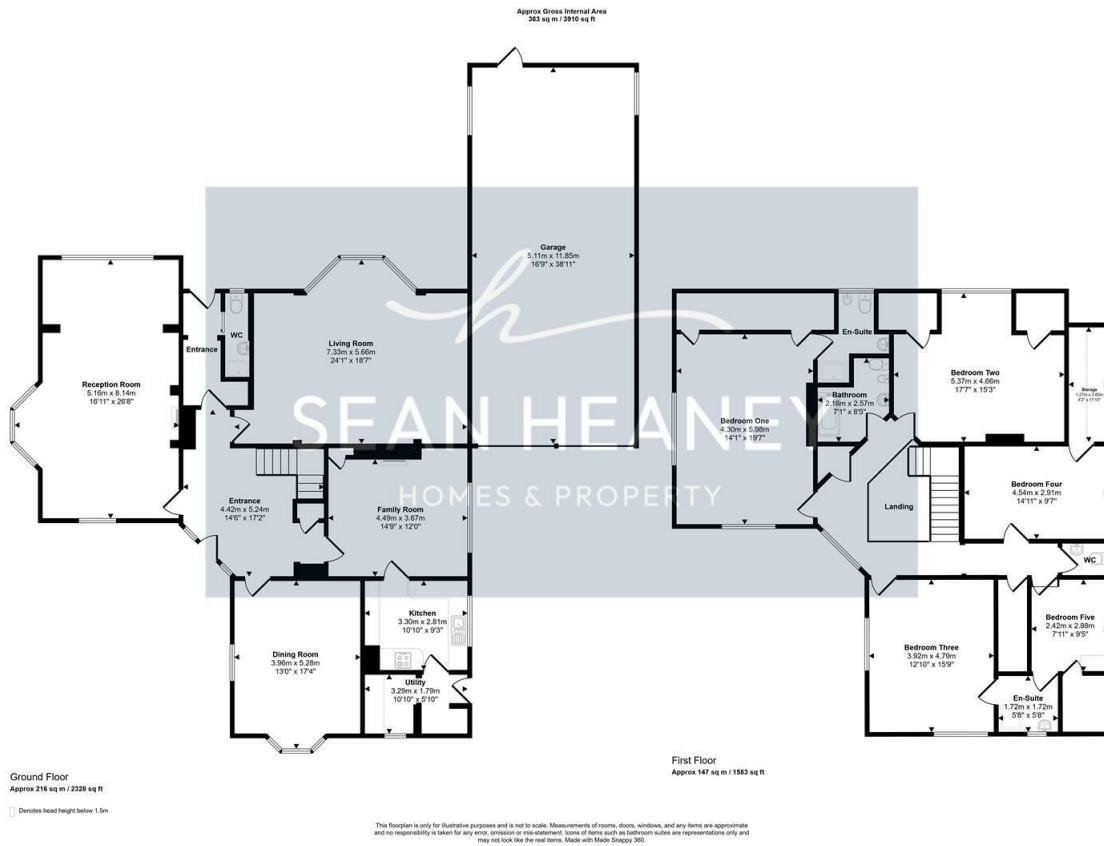

Viewing

Please contact our Barnet Office on 020 8441 7173 if you wish to arrange a viewing appointment for this property or require further information.

1. Please note that we have not tested any apparatus, equipment, fixtures, fittings or services, and so cannot verify they are in working order, or fit for their purpose. A buyer is advised to obtain verification from their Solicitor or Surveyor.
2. References to the tenure of a property are based on information supplied by the seller. The agent has not had sight of the title documents. A buyer is advised to obtain verification from their Solicitor.
3. Room measurements have been made using a Laser Meter. Complete accuracy cannot be guaranteed and therefore the room sizes given should be regarded as being approximate.
4. Photographs are for illustration only and may depict items which are not for sale or included in the sale of the property.
5. Floor plans remain copyright of Sean Heaney Estate Agents and are not to be copied in part or full without written consent, are provided for illustrative purposes only and are not to scale.

Area Map



Energy Efficiency Graph

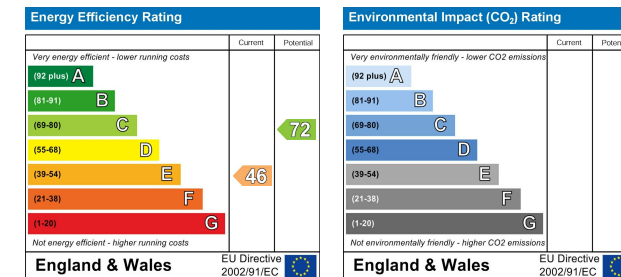

Highstone House, 165 High Street, Barnet, Hertfordshire, EN5 5SU

T: 020 8441 7173 E: sales@seanheaney.co.uk W: www.seanheaney.co.uk